

20FT IVECO MOBILE CLINIC



★ HIGH QUALITY ★ ON-TIME DELIVERY ★ COMPETITIVE PRICE



 Plot No. S21504, Jebel Ali Free Zone South,
P.O. Box 487449, Dubai, UAE

 +971 4 884 4860
+971 50 880 4579

 sales@abronn.com
www.abronn.com



INTERIOR DESIGN



LABORATORY ROOM



GENERAL CLINIC



EXAMINATION TABLE



TOILET & WASHROOM



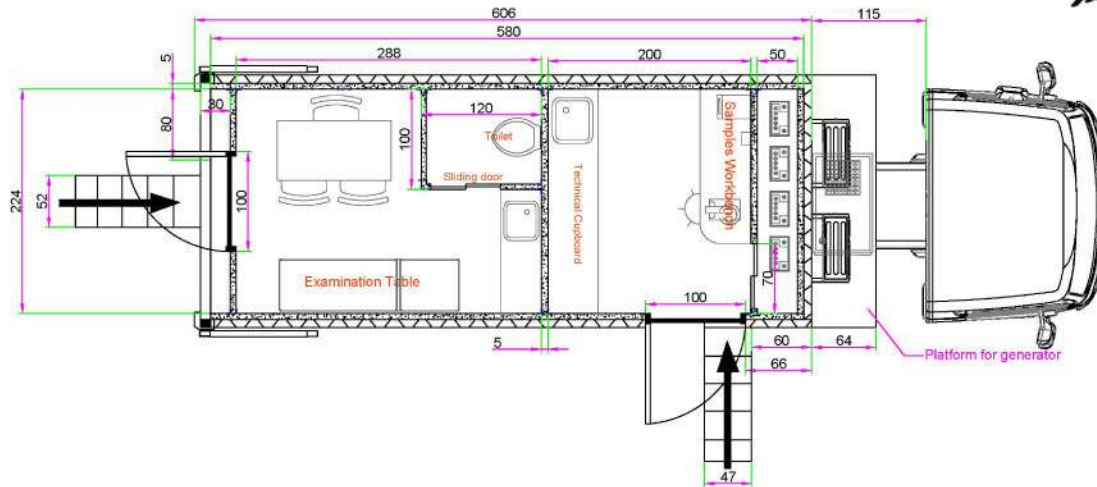

SPECIFICATION



CABIN COMPARTMENT FITTINGS

- Fabrication of the clinic Box
- Walls: 50mm thick PU Sandwich panel (Outside 0.40mm thick Low/NO ribs Aluminum sheet and inside 0.40mm thick low rib GI sheet with 50mm thick PU insulation of Density 38kg/m3)
- Ceiling: 50mm thick PU Sandwich panel (Outside 0.40mm thick low rib Aluminum sheet and inside 0.40mm thick low rib GI sheet with 50mm thick PU insulation of Density 38kg/m3)
- Flooring: 2.00mm (Marine plywood flooring covered with anti-bacterial, anti-slip vinyl) on top of 18mm thick Cement Board Deck (Green Color Vinyl)
- Paint: External container skin Acrylic PU paint finish over Epoxy primer 3 coat Waterproofing system on container roof
- Doors & windows: Insulated Doors with Demountable Type hand rails made from Aluminum, double glass 2 no's Glass Door 0.90x2.10 Manual Hinged Retractable Rear and Side Stair Case with Hand Rail Support

CLINIC PARTITION

- General Clinic:
 - Portable toilet and shower in the corner
 - Workbench with Stainless Steel sink with filters integrated
 - Desk and Rotating Chair for the staff
 - Examination Table
- Laboratory room:
 - Sample workbench + stool
 - Technical storage cupboard with SS Sink
 - Laboratory Stool
- Toilet and Wash Room:
 - Portable toilet and shower in the corner
 - Wash Room with Hot/Cold water in sink, toilet and shower curtains
 - Dispensers for : Soap, Alcohol and Paper Towels
 - Portable Hot water boiler 5L



SPECIFICATION



ELECTRICAL SYSTEM

- 6 KVA Silent Generator (Diesel Engine), water cooled with Inverter, Junction Box, all electrical power sockets (KUBOTA, HONDA or Perkins Only)
- Three Phase Electrical Switch Board Complete with basic electrical fixtures and accessories. LED Downlights (Milano or eq.), Wires (Brand- Tekab), DB (Brand Hager)
- Electric Control switchboard and fusebox
- Ventilation fans, 1 in each room
- 220V Outlets + 12V Sockets , distributed in the sections
- LED ceiling lighting for each section and room + Night lights
- Reverse alarm with warning Light

- 2x Rear outside spotlights
- Split Type AC System for cooling and heating (2.5kW) with 2 step air filtration system, G4 and F7, with additional filters spare parts
- Automatic loaded hand flashlight
- 2x Digital Wall Clock
- Intercom system between the driver cabin and the rear compartment Shoreline 220V - 240V (Switch 1)
- Solar panel, 2x battery 10KVA each, Charge Controller, DC Solar ON/OFF
- Main switch, UPS (10KVA), Fuses for solar panel, additional automatic battery charger



SPECIFICATION



WATER SYSTEM

- 3 Step water treatment system with 70 micron, 5 micron and then UV light purification system
- Portable Hot water boiler 5L
- Clean and waste water tanks, atleast 300L mounted on the truck chassis
- Tanks equipped with water level indicator and have open valve for easier cleaning
- All Stainless Steel taps inside the clinic with hot and cold water

- Dispensers for : Soap, Alcohol and Paper Towels
- Wash Room with Hot/Cold water in sink, toilet and shower curtains
- Waste Water tank volume capacity: 300 litres, connecting pipes, valve
- Fresh Water tank volume capacity: 300 litres
- Wash Basin: Water treatment tank
- Complete plumbing system: drainage pipe, normal water pipe and hot water pipe

